

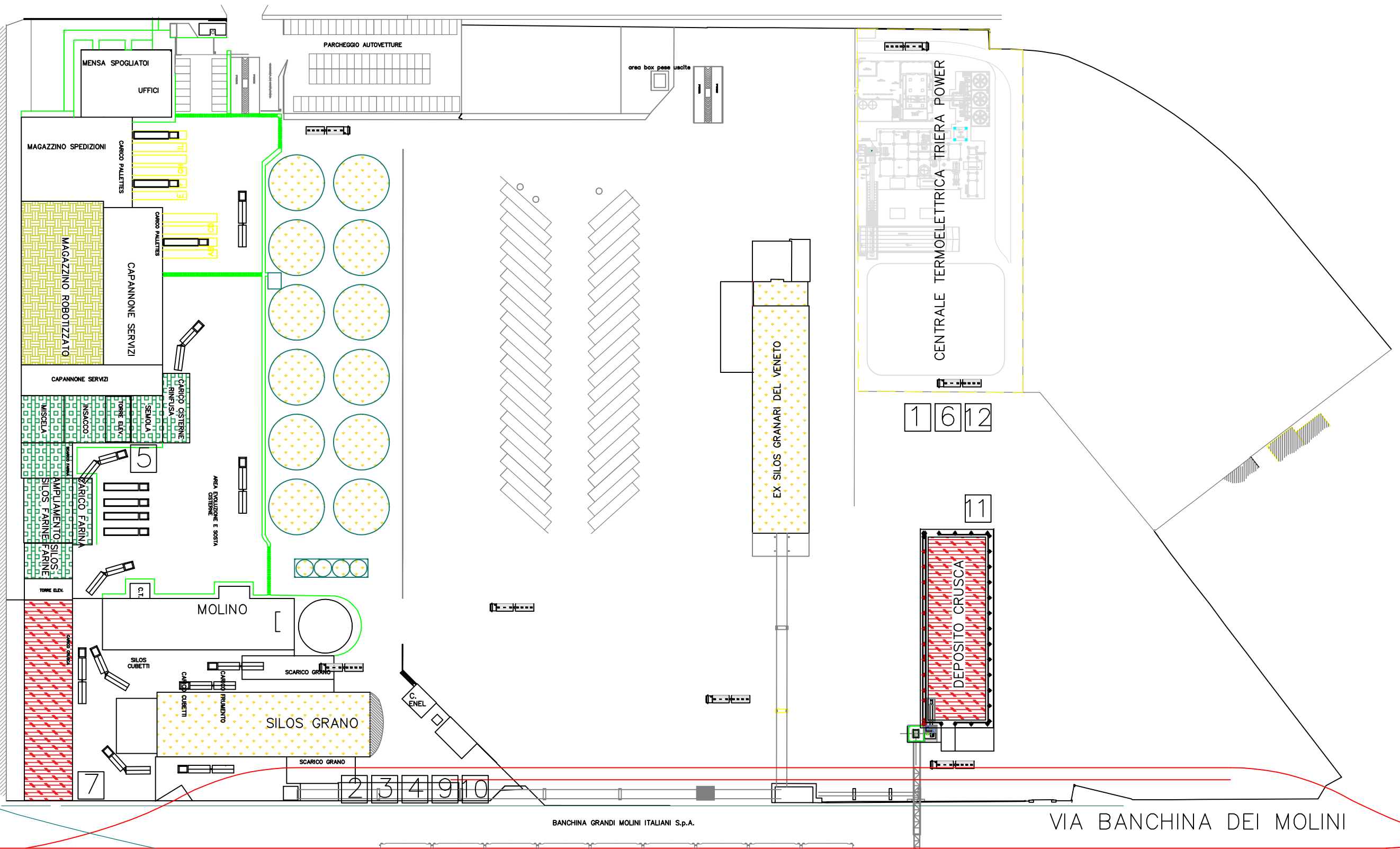



VIA DELL'ELETTRICITA'

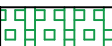

-  A – SILOS GRANO
-  B – CELLE FARINA
-  C – MAGAZZINO VERTICALE
-  D – MAGAZZINO COPRODOTTI

Riproduzione cartacea del documento informatico sottoscritto digitalmente da
 ENRICO FABRIS il 21/07/2025 18:44:21
 ai sensi dell'art. 20 e 23 del D.lgs 82/2005
 PROTOCOLLO GENERALE: 2025 / 56668 del 20/08/2025

GRANDI MOLINI ITALIANI spa
 Allegato C.11 – PLANIMETRIA STABILIMENTO
 rev.0 del 24.06.2024